

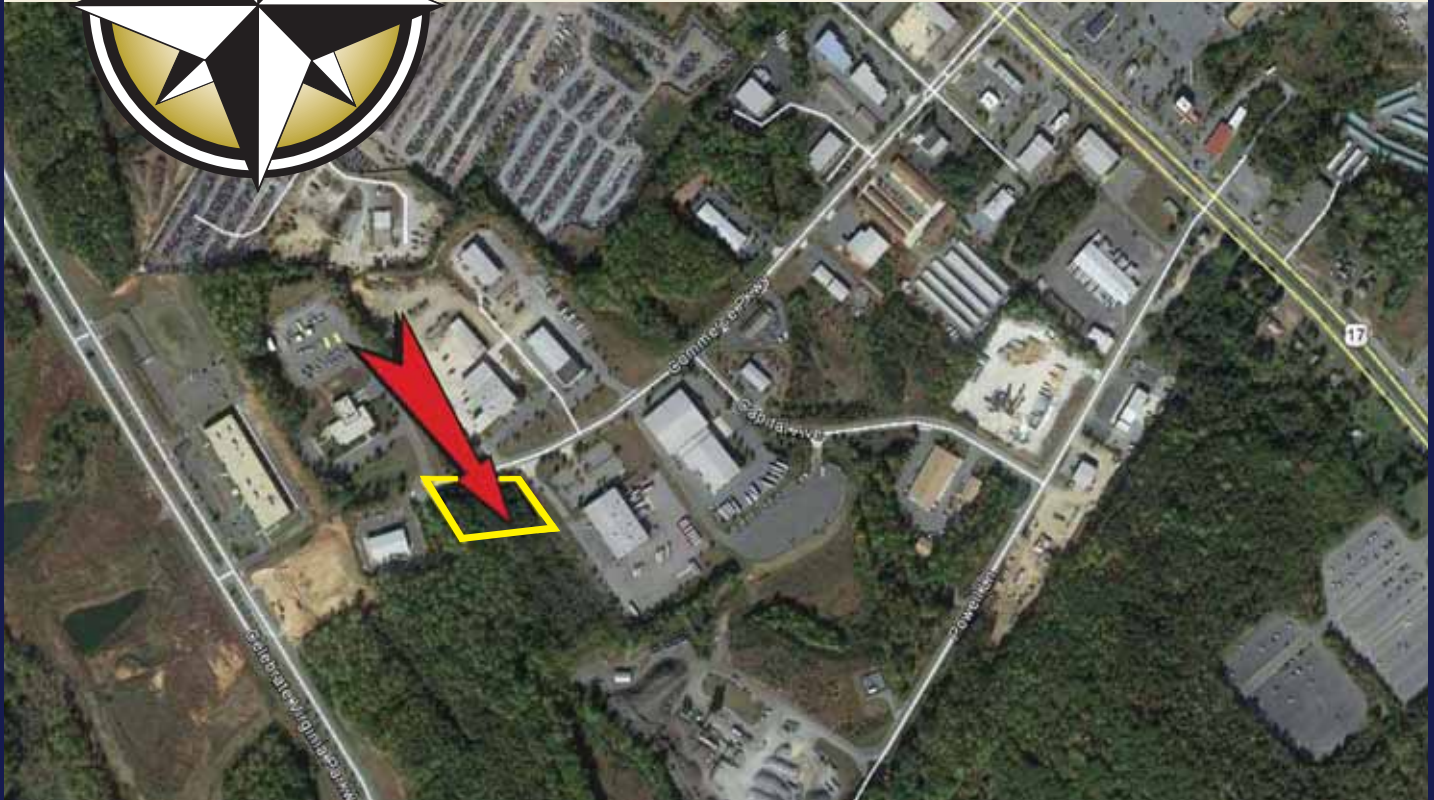

Heritage Commerce Park

63 Commerce Parkway, Fredericksburg, VA 22406

Industrial Land for Sale



Presented by:

David K. Blackwood

Blackwood Real Estate, Inc.

Commercial Real Estate Brokerage

“CREATING VALUE THROUGH SERVICE EXCELLENCE”

10950 Pierson Drive, Suite 600 • Fredericksburg, Virginia 22408

(540) 710-8800 Phone • (540) 710-6743 Fax

david@blackwoodrealestate.com

Notice of Disclaimer

The following information has been obtained from sources deemed to be reliable. No representation is made as to the accuracy of the information, and is submitted subject to changes of price information, prior sale, or withdrawal without notice. Broker makes no representation as to the location of any sewer or water lines, sewer laterals, water lines or the suitability of drain fields or wells and suitability of well water. The Broker accepts no responsibility or liability for inconsistencies or for defects which may be discovered through purchasers' investigations.



Blackwood Real Estate, Inc. is pledged to the letter and spirit of U.S. policy for the achievement of equal housing opportunity throughout the nation. We encourage and support an affirmative advertising marketing program in which there are not barriers to obtaining housing because of race, color, religion, sex, national origin, handicap, age or familial status.

Heritage Commerce Park

63 Commerce Parkway, Fredericksburg, VA 22406

Industrial Land For Sale

Project: Heritage Commerce Park is a mixed use industrial park. Uses range from sales and service, manufacturing and distribution to warehouses.

Location: Heritage Commerce Park is located on the south side of Route 17, approximately 1.1 miles west of the intersection of Route 17 and Interstate 95 in south Stafford County. The property is located in the Falmouth Magisterial District next to the Coca-Cola distribution facility and across the street from Carter CAT (Caterpillar Dealer).

Property: The property comprises 1.97 acres of Industrial land that is zoned M-1 (Industrial). The M-1 zone is a general industrial zone, which has a wide range of permitted uses. This property has approximately 260 feet of frontage along Commerce Parkway.

Use: This property is well suited for warehouse and distribution as well as small warehouses for lease or sale.

Price: The land is priced at \$700,000.00. Price includes the engineering, using seller's engineer, and seller will grade the site to purchaser's site plan.

Terms: Cash

Utilities: All utilities can be made available to the site including natural gas.

Map Location

Contents and Key to Abbreviations. Take a few minutes to familiarize yourself with this time-saving information.

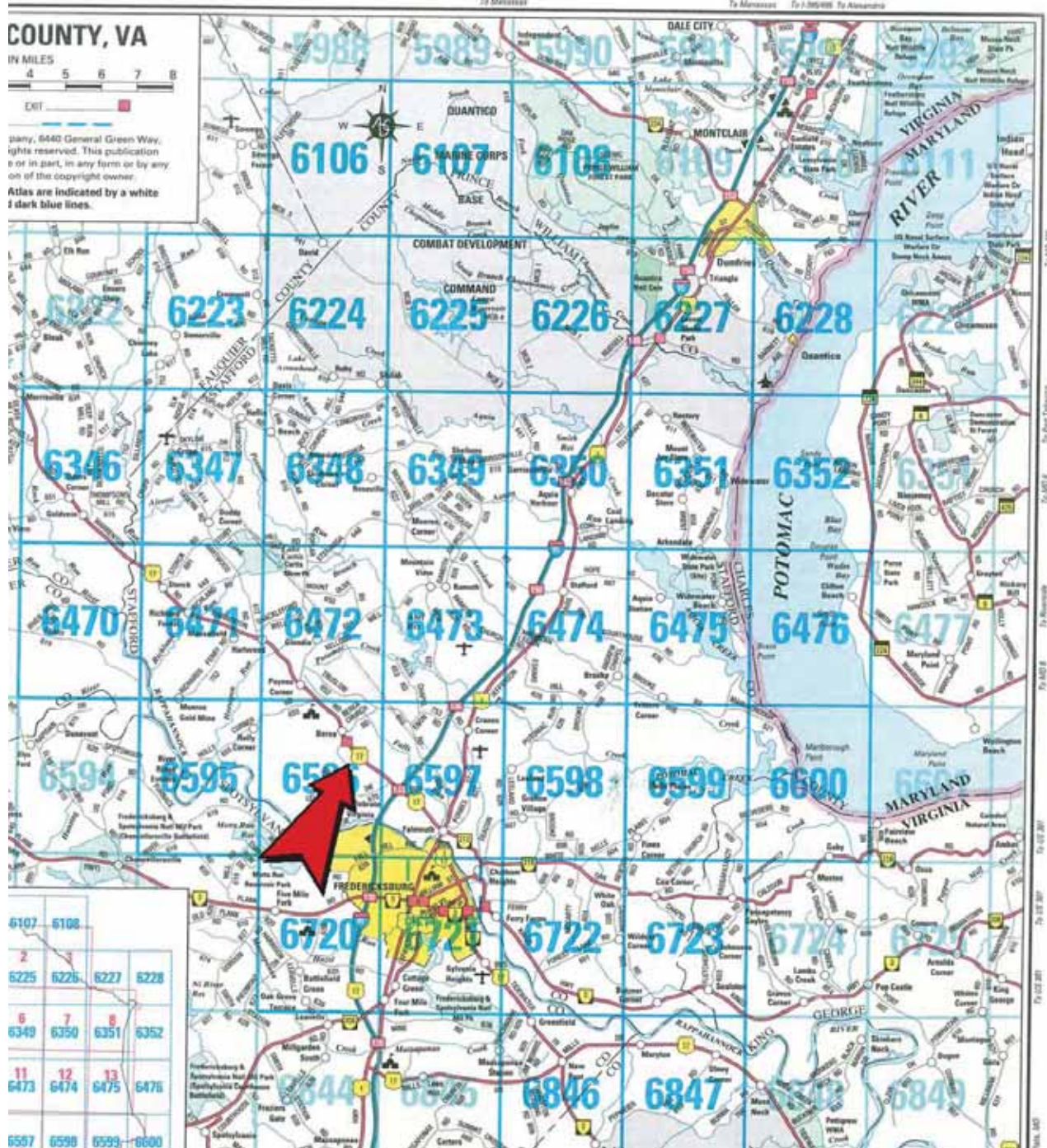

Map Location



Tax Map

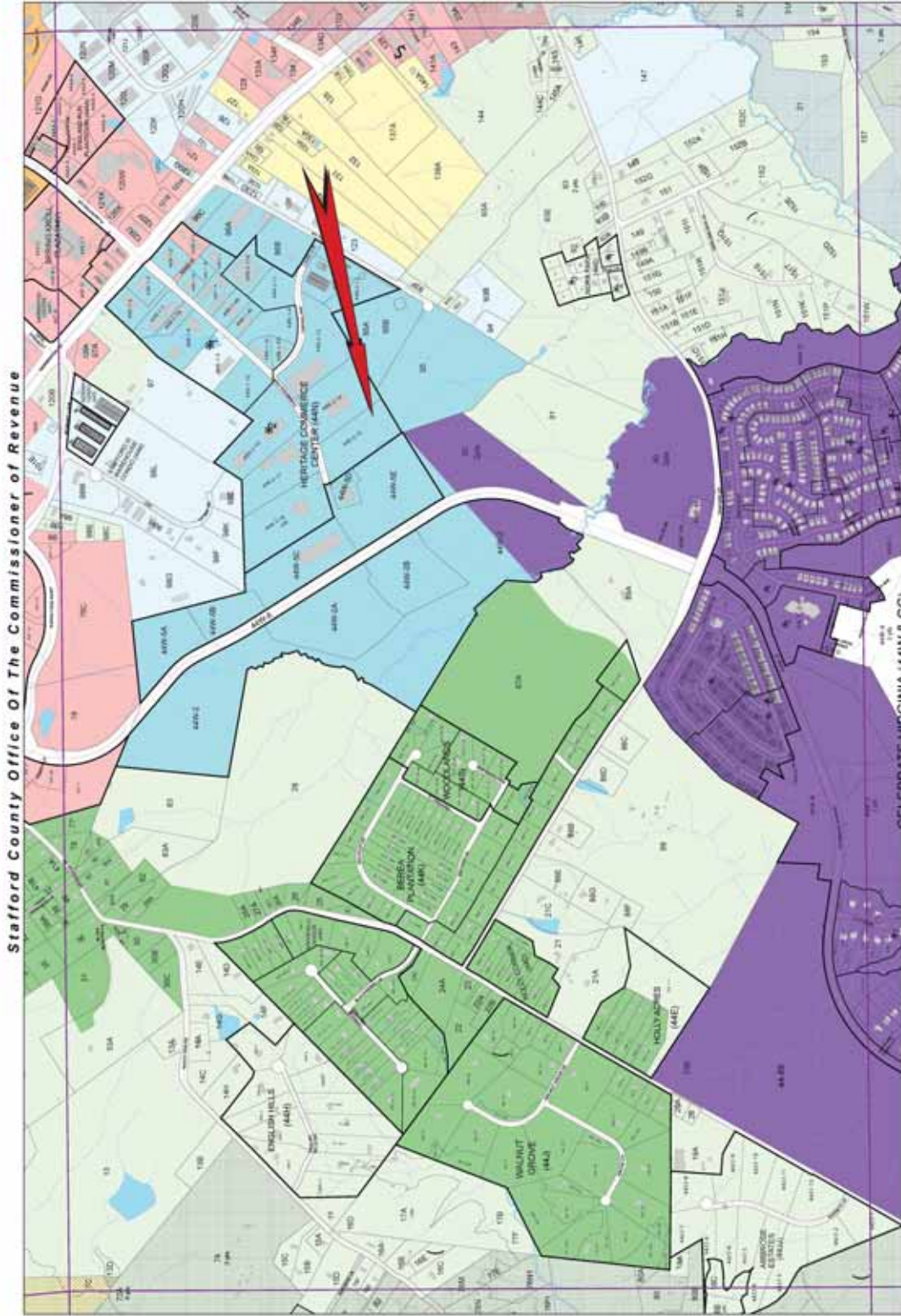

Stafford County Office Of The Commissioner of Revenue



Tax Map 44South

STAFFORD COUNTY, GEORGIA
 THE COMMISSIONER OF REVENUE
 1000 W. STATE STREET, SUITE 100
 STAFFORD, GEORGIA 30282
 (770) 336-2200
 WWW.STAFFORDCOUNTYGA.GOV

- Zoning**
- 41 Single-Family Detached
 - 42 Single-Family Detached
 - 43 Single-Family Detached
 - 44 Single-Family Detached
 - 45 Single-Family Detached
 - 46 Single-Family Detached
 - 47 Single-Family Detached
 - 48 Single-Family Detached
 - 49 Single-Family Detached
 - 50 Single-Family Detached
 - 51 Single-Family Detached
 - 52 Single-Family Detached
 - 53 Single-Family Detached
 - 54 Single-Family Detached
 - 55 Single-Family Detached
 - 56 Single-Family Detached
 - 57 Single-Family Detached
 - 58 Single-Family Detached
 - 59 Single-Family Detached
 - 60 Single-Family Detached
 - 61 Single-Family Detached
 - 62 Single-Family Detached
 - 63 Single-Family Detached
 - 64 Single-Family Detached
 - 65 Single-Family Detached
 - 66 Single-Family Detached
 - 67 Single-Family Detached
 - 68 Single-Family Detached
 - 69 Single-Family Detached
 - 70 Single-Family Detached
 - 71 Single-Family Detached
 - 72 Single-Family Detached
 - 73 Single-Family Detached
 - 74 Single-Family Detached
 - 75 Single-Family Detached
 - 76 Single-Family Detached
 - 77 Single-Family Detached
 - 78 Single-Family Detached
 - 79 Single-Family Detached
 - 80 Single-Family Detached
 - 81 Single-Family Detached
 - 82 Single-Family Detached
 - 83 Single-Family Detached
 - 84 Single-Family Detached
 - 85 Single-Family Detached
 - 86 Single-Family Detached
 - 87 Single-Family Detached
 - 88 Single-Family Detached
 - 89 Single-Family Detached
 - 90 Single-Family Detached
 - 91 Single-Family Detached
 - 92 Single-Family Detached
 - 93 Single-Family Detached
 - 94 Single-Family Detached
 - 95 Single-Family Detached
 - 96 Single-Family Detached
 - 97 Single-Family Detached
 - 98 Single-Family Detached
 - 99 Single-Family Detached
 - 100 Single-Family Detached
- Other Symbols**
- 101 Water
 - 102 Wetlands
 - 103 Flood Hazard
 - 104 Flood Hazard
 - 105 Flood Hazard
 - 106 Flood Hazard
 - 107 Flood Hazard
 - 108 Flood Hazard
 - 109 Flood Hazard
 - 110 Flood Hazard
 - 111 Flood Hazard
 - 112 Flood Hazard
 - 113 Flood Hazard
 - 114 Flood Hazard
 - 115 Flood Hazard
 - 116 Flood Hazard
 - 117 Flood Hazard
 - 118 Flood Hazard
 - 119 Flood Hazard
 - 120 Flood Hazard
 - 121 Flood Hazard
 - 122 Flood Hazard
 - 123 Flood Hazard
 - 124 Flood Hazard
 - 125 Flood Hazard
 - 126 Flood Hazard
 - 127 Flood Hazard
 - 128 Flood Hazard
 - 129 Flood Hazard
 - 130 Flood Hazard
 - 131 Flood Hazard
 - 132 Flood Hazard
 - 133 Flood Hazard
 - 134 Flood Hazard
 - 135 Flood Hazard
 - 136 Flood Hazard
 - 137 Flood Hazard
 - 138 Flood Hazard
 - 139 Flood Hazard
 - 140 Flood Hazard
 - 141 Flood Hazard
 - 142 Flood Hazard
 - 143 Flood Hazard
 - 144 Flood Hazard
 - 145 Flood Hazard
 - 146 Flood Hazard
 - 147 Flood Hazard
 - 148 Flood Hazard
 - 149 Flood Hazard
 - 150 Flood Hazard
 - 151 Flood Hazard
 - 152 Flood Hazard
 - 153 Flood Hazard
 - 154 Flood Hazard
 - 155 Flood Hazard
 - 156 Flood Hazard
 - 157 Flood Hazard
 - 158 Flood Hazard
 - 159 Flood Hazard
 - 160 Flood Hazard
 - 161 Flood Hazard
 - 162 Flood Hazard
 - 163 Flood Hazard
 - 164 Flood Hazard
 - 165 Flood Hazard
 - 166 Flood Hazard
 - 167 Flood Hazard
 - 168 Flood Hazard
 - 169 Flood Hazard
 - 170 Flood Hazard
 - 171 Flood Hazard
 - 172 Flood Hazard
 - 173 Flood Hazard
 - 174 Flood Hazard
 - 175 Flood Hazard
 - 176 Flood Hazard
 - 177 Flood Hazard
 - 178 Flood Hazard
 - 179 Flood Hazard
 - 180 Flood Hazard
 - 181 Flood Hazard
 - 182 Flood Hazard
 - 183 Flood Hazard
 - 184 Flood Hazard
 - 185 Flood Hazard
 - 186 Flood Hazard
 - 187 Flood Hazard
 - 188 Flood Hazard
 - 189 Flood Hazard
 - 190 Flood Hazard
 - 191 Flood Hazard
 - 192 Flood Hazard
 - 193 Flood Hazard
 - 194 Flood Hazard
 - 195 Flood Hazard
 - 196 Flood Hazard
 - 197 Flood Hazard
 - 198 Flood Hazard
 - 199 Flood Hazard
 - 200 Flood Hazard

1:4,800
 Only used for 44S and 44N zones
 Other zones are 2428 symbols



Tax Map 44South

Aerial Map Location



Plat Map

PLAT BOOK 34 PAGE 185

COLUMBIA GAS
LOT 18
TAX MAP 44, PARCEL 96D
#980018473
PB 32, PG 108
10.0000 ACRES

PHASE 11
PB 21, PG 18-23

EXISTING TEMPORARY
TURNAROUND EASEMENT
PB 21, PG 25

EXISTING WATER
EASEMENT
PB 21, PG 25

EXISTING 20' TURNAROUND
EASEMENT
PB 32, PG 108

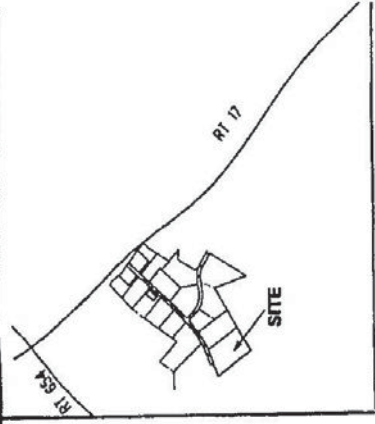

COCCA-COLA ENTERPRISES, INC.
TAX MAP 44N-2-14A
LOT 14A
980025627
PB 32, PG 247

MULBERRY CORPORATION
TAX MAP 44N-2-15
LOT 15A
3.7374 ACRES
ZONED: M-2
DB 1153, PG 659
PB 32, PG 247

LOT 15A-1
6.1678 ACRES

2.4304 ACRES
OUT OF TAX MAP 44A, PARCEL 96
ZONED: M-2

MULBERRY CORPORATION
TAX MAP 44, PARCEL 96
#980018473
DB 1153, PG 659

124.9796 ACRES (RESIDUE AFTER BOUNDARY LINE ADJUSTMENT)

JK. STONE CORPORATION
TAX MAP 44, PARCEL 95
#980018475
DB 1153, PG 659
PB 32, PG 247

SUBDIVIDERS & OWNERS ADDRESS
MULBERRY CORPORATION
C/O WACHOVIA BANK
CREO MANAGEMENT GROUP
1401 MAIN STREET, SUITE 342

CERTIFICATE OF TITLE

...PROVE THAT HEREBY CORPORATION ADMITS TITLE TO



